

Traffic Control Services  
Equipment Rentals  
Permits & Consulting  
Traffic Engineering

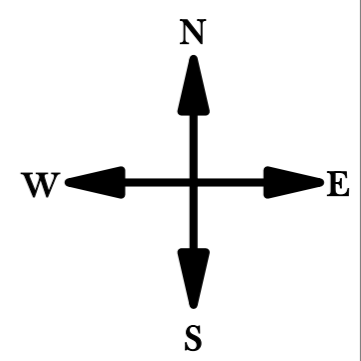

**LEGEND**

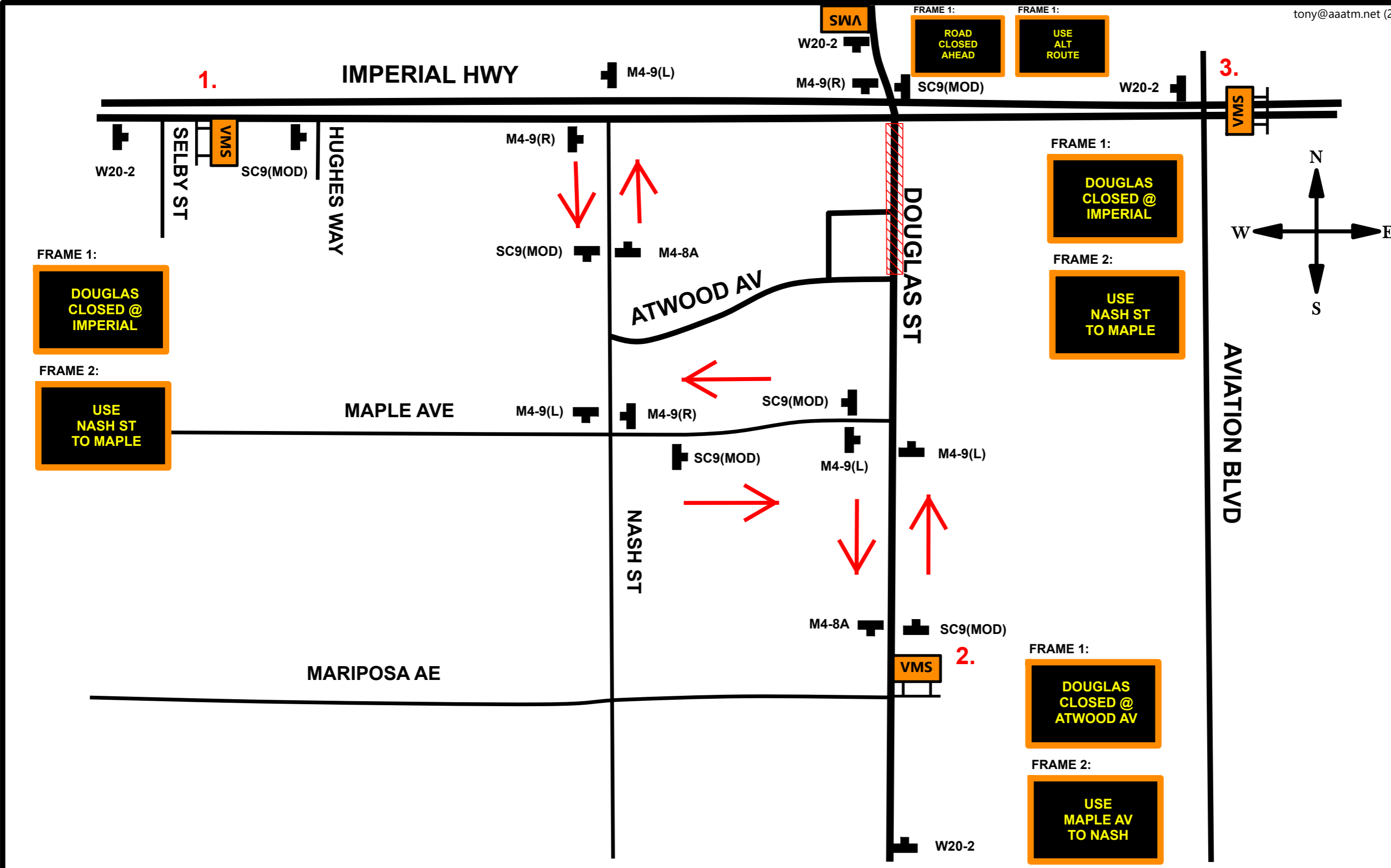
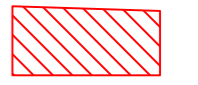
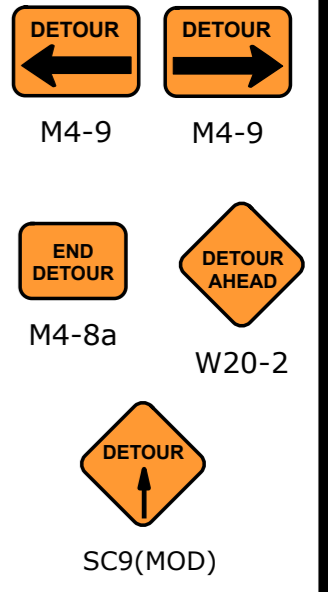

CLOSURE



CMS BOARD



TYPE 2 A-FRAME WITH SIGN

OFFICE: (213) 747-0215

<b>LASF 2019</b>			
SCALE: NOT TO SCALE DRAWN BY: S.F.	SEP. 16 8PM - SEP 23 1PM	V#:2	DATE MADE: 6/1/2019
<b>DETOUR PLAN</b>			
© A+ TRAFFIC MANAGEMENT INC, 2019 - 2020. ALL RIGHTS RESERVED			SHEET NO: <b>1 OF 3</b>

1. ALL SIGNS, STRIPES, DELINEATORS, BARRICADES AND OTHER TRAFFIC CONTROL DEVICES AND THEIR INSTALLATION SHALL CONFORM TO THE LATEST EDITIONS OF THE FOLLOWING DOCUMENTS: THE STATE OF CALIFORNIA STANDARD SPECIFICATIONS, AND THE CALIFORNIA MANUAL ON UNIFORM TRAFFIC CONTROL DEVICES. IN THE EVENT OF CONFLICT BETWEEN THESE TWO DOCUMENTS, THE MOST STRINGENT REQUIREMENT SHALL APPLY. SIGN SIZES SHALL BE THOSE SHOWN AS "STANDARD", OR LARGER, IN THE CALIFORNIA MANUAL ON UNIFORM TRAFFIC CONTROL DEVICES.