

S:\PROJECTS\1853.000- NG El Segundo\1559.20 Revised St Vac-Add Exhibit Maps\SURVEY\EXHIB\SHEETS\Exhibit-MTA & LA Times Esmts.dwg/2022 5:35 PM

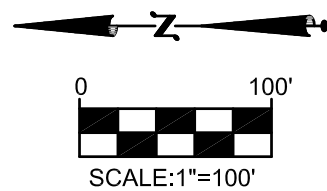

AVIATION

BOULEVARD

IMPERIAL HIGHWAY

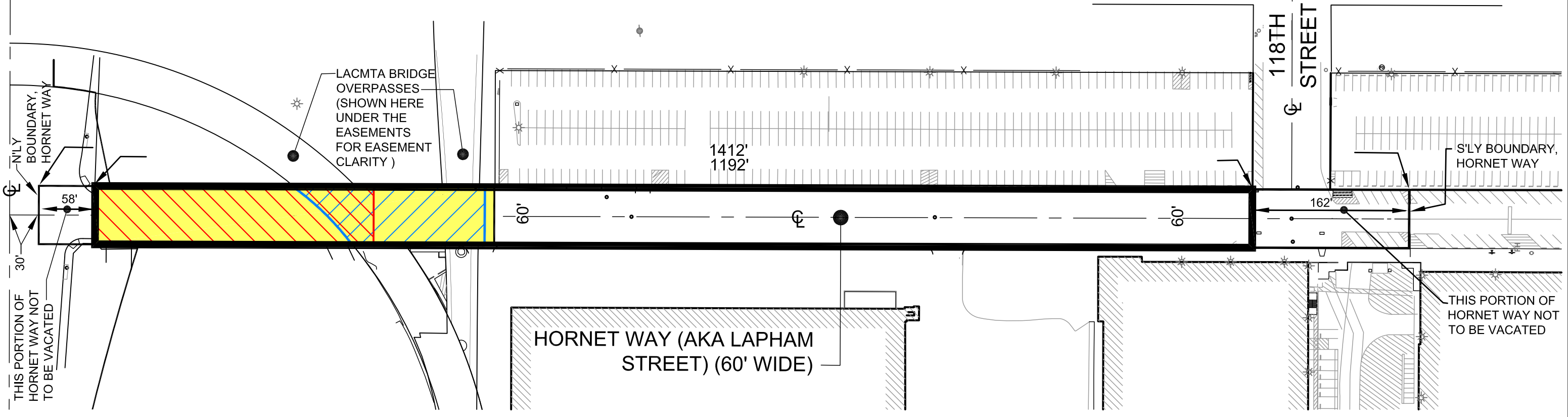

BOUNDARY OF PORTION OF HORNET WAY PROPOSED FOR STREET VACATION



BOUNDARY OF "ACCESS AND UTILITIES EASEMENT AREA" (PART OF "EASEMENT AGREEMENT")
 RECORDED: 4/08/22, INSTR. NO. 20220391788
 GRANTOR: HC HORNET WAY, LLC
 GRANTEE: LACMTA
 PURPOSE: ACCESS, INGRESS AND EGRESS AND UTILITIES

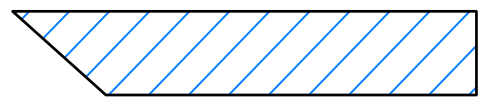

BOUNDARY OF "AERIAL EASEMENT AREA" AND "AERIAL GUIDEWAY EASEMENT AREA" (PART OF "EASEMENT AGREEMENT")
 RECORDED: 4/08/22, INSTR. NO. 20220391788
 GRANTOR: HC HORNET WAY, LLC
 GRANTEE: LACMTA
 PURPOSE: RAIL GUIDEWAYS

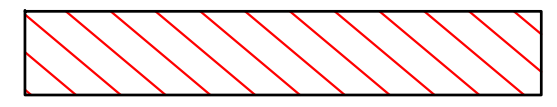

BOUNDARY OF "ACCESS EASEMENT AGREEMENT" RECORDED: 5/12/21, INSTR. NO. 20210759951
 GRANTOR: HC HORNET WAY, LLC
 GRANTEE: 2310 IMPERIAL, LLC
 PURPOSE: ACCESS AND INGRESS AND EGRESS

PREPARED BY: 17625 Crenshaw Blvd., Ste. 300
 Torrance, California 90504
 Tel: (310) 327-0018 / Fax: (310) 327-0175

DCA CIVIL ENGINEERING GROUP
 www.dcacivileng.com

© 2022 DCA CIVIL ENGINEERING GROUP ALL RIGHTS RESERVED
 • CIVIL ENGINEERING • LAND PLANNING • SURVEYING & MAPPING • A.L.T.A. SPECIALISTS

EXHIBIT MAP

SHOWING EXISTING EASEMENTS WITHIN THE PORTION OF HORNET WAY PROPOSED TO BE VACATED

SCALE: AS SHOWN	DATE: 08/09/2022
BY: KMR	J.N. 22-2261-1853.000-1559.20