



EA-1361 and AUP 24-03

Alcohol service at a restaurant at membership-only Recreation Center for:

“California Smash Pickleball and Social Club.”

811-815 N. Nash Street.

Aerial View of Site

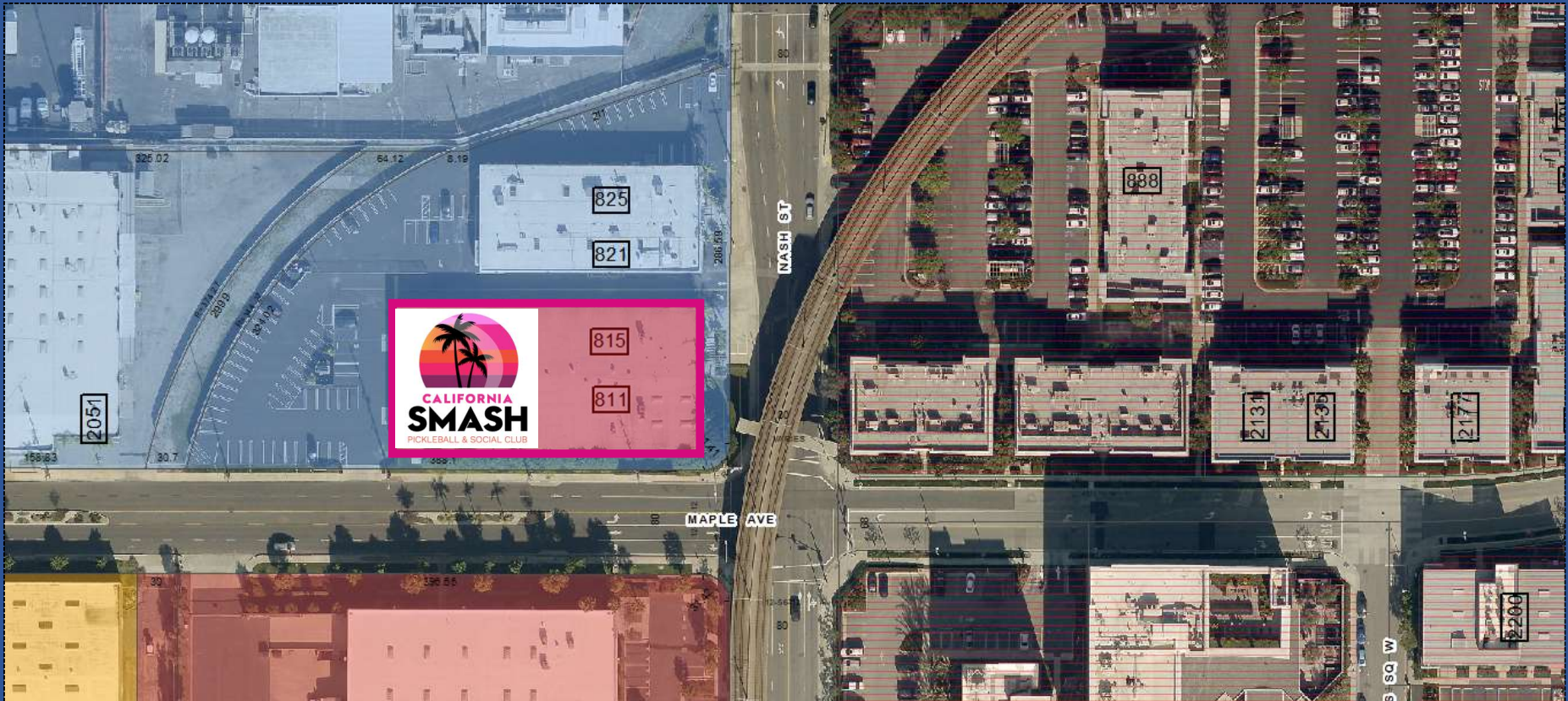

Site Plan

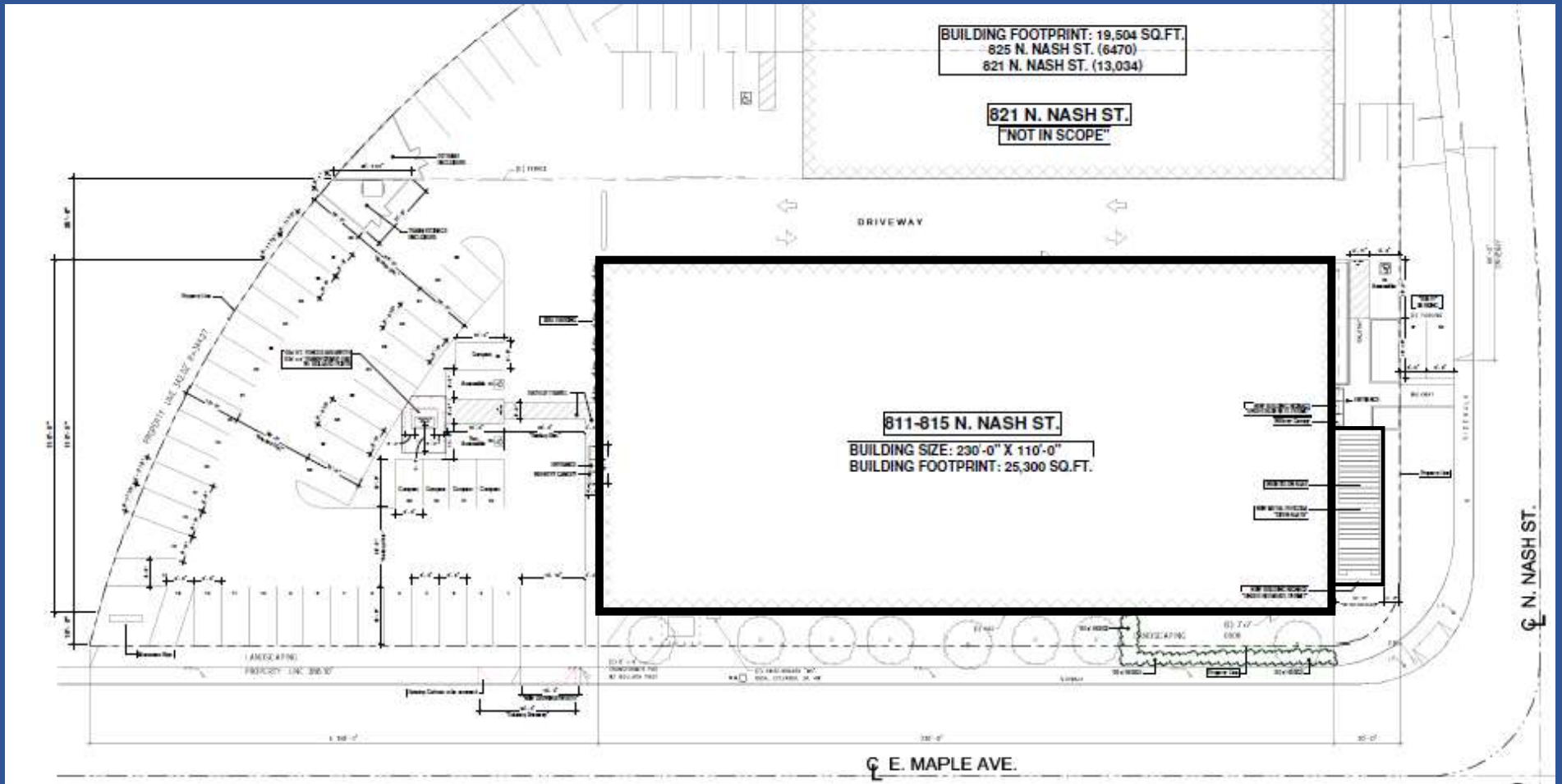

Project Description:

1. An AUP to allow alcohol service (Type 47 ABC License) at a new Restaurant from 7 a.m. to 11 p.m. Monday through Thursday, 8 a.m. to 1 a.m. Friday and Saturday, and 7 a.m. to 10 p.m. Sunday.
2. Food and alcohol service is proposed for the interior dining area of the Restaurant, 3 waiting areas adjacent to the Pickleball courts, a media/meeting room, and an outdoor dining area.
3. A Disc Jockey will play music from a mezzanine in the evenings on weekends, and karaoke will be available in a media/meeting room. (An Entertainment Permit is required from the Police Chief).

Floor Plan

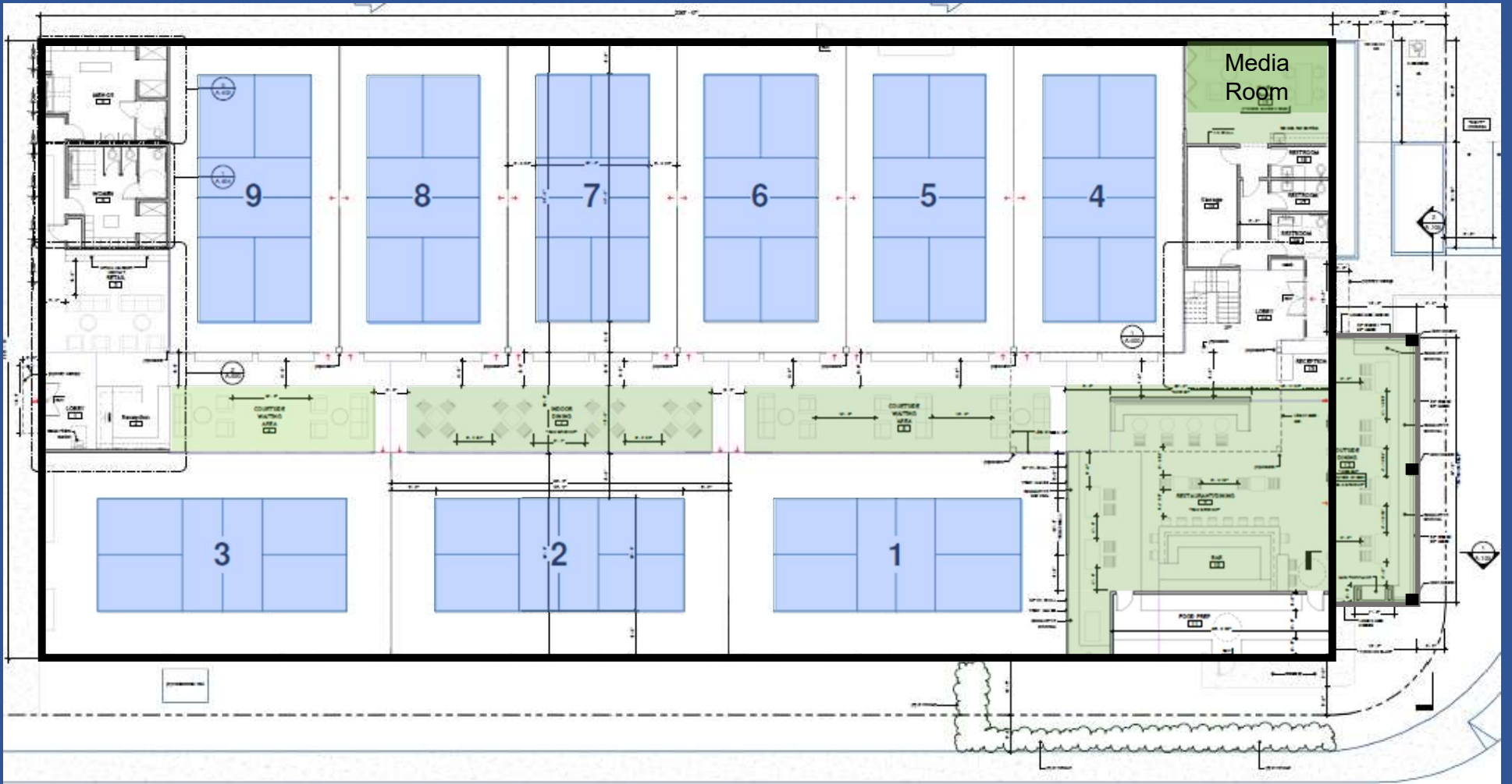

Rendering of Pickleball Courts



AUP Required Findings:

1. There is compatibility of the particular use on the particular site in relationship to other existing and potential uses within the general area in which the use is proposed to be located.
2. The proposed use is consistent and compatible with the purpose of the zone in which the site is located.
3. The proposed location and use and the conditions under which the use would be operated or maintained to not be detrimental to the public health, safety, or welfare, or materially injurious to properties or improvements in the vicinity.
4. Potential impacts that could be generated by the proposed use, such as noise, smoke, dust, fumes, vibration, odors, traffic and hazards have been recognized and compensated for.
5. The State Department of Alcohol Beverage Control has issued or will issue a license to the applicant.

Recommendation:

- Receive and File, conditionally approving Environmental Assessment No. EA-1361 and Administrative Use Permit No. AUP 24-03.

